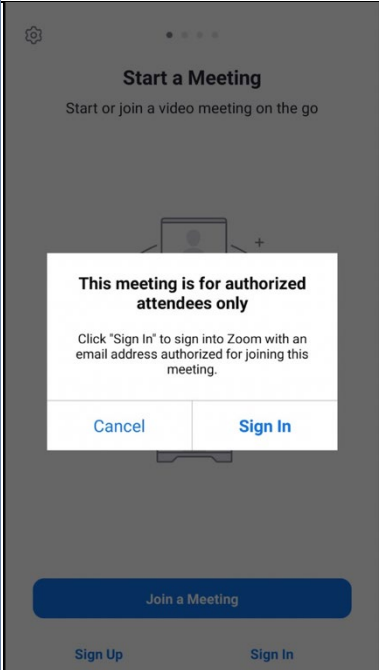
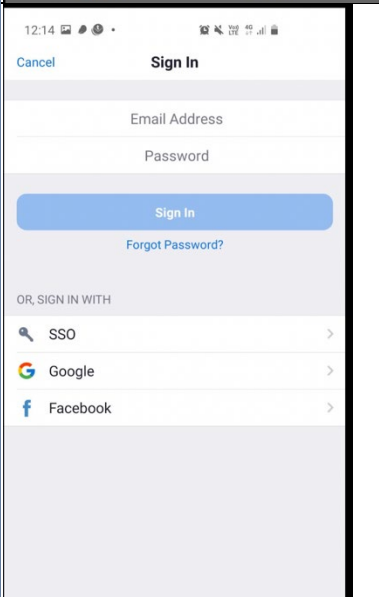

# Zoom 'How To'

## Steps for login via the APP on an iPad, tablet or iPhone

1	Join Zoom via the LINK sent to you from the classroom teacher.	
2	A screen will come up saying 'this meeting is for authorised personnel only'.  Click 'sign in'	
3	At this step click the button with the 'key' that has SSO written next to it.	

4 Your screen should then say  
nsweducation.zoom.us

If it DOESN'T – type 'nsweducation' into the box.

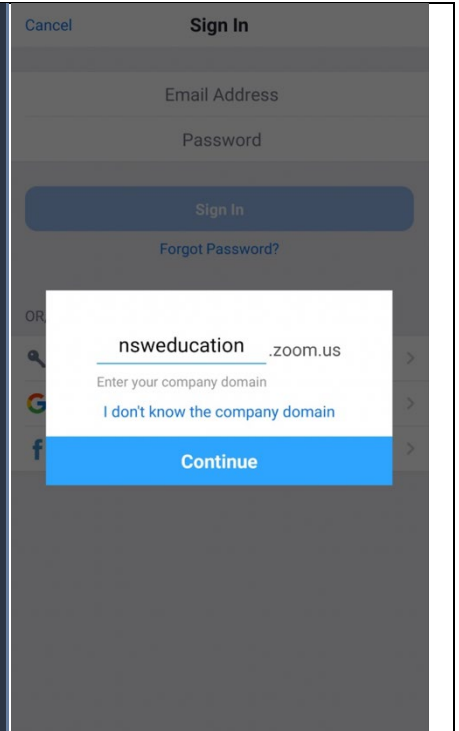

At this step you will need to enter your username  
and password WITHOUT the @detnsw or  
@det.nsw.edu.au

E.g. Kate.townsend2

NOT

[Kate.townsend@detnsw](mailto:Kate.townsend@detnsw)

Or [kate.townsend@det.nsw.edu.au](mailto:kate.townsend@det.nsw.edu.au)

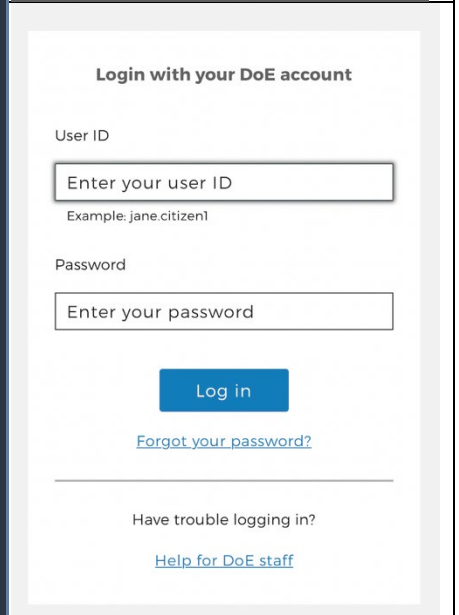

## Steps for login via internet browser on Laptop/Desktop Computers

1 Join Zoom via the LINK sent to you from the classroom teacher.

2 A screen will come up saying 'Sign in'

You click Sign in with SSO showing a 'key' next to it.

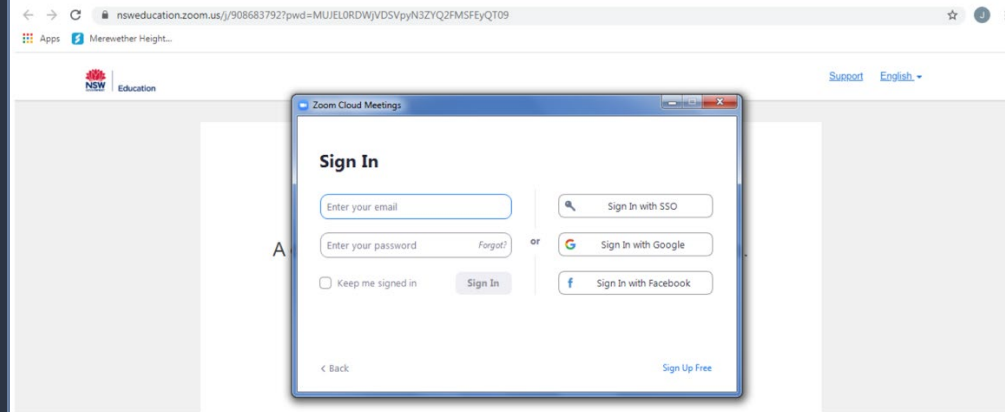

3 Type 'nsweducation' into this box and click continue.

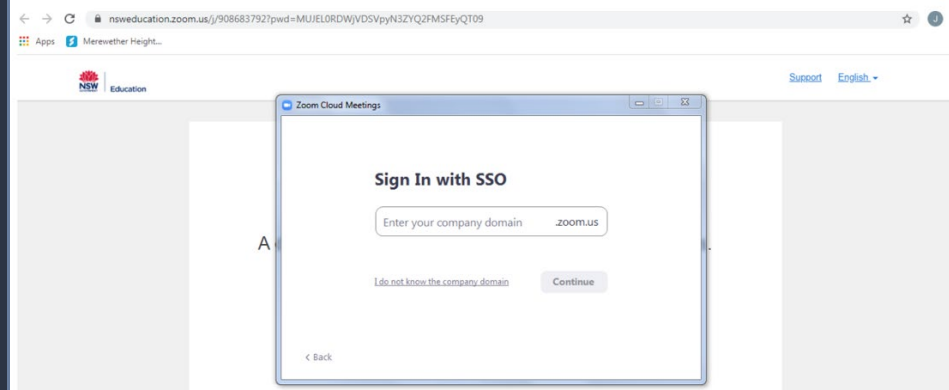

4 At this step you will need to enter your username and password WITHOUT the @detnsw or @det.nsw.edu.au

E.g. Kate.townsend2

NOT

[Kate.townsend@detnsw](mailto:Kate.townsend@detnsw)

Or

[kate.townsend@det.nsw.edu.au](mailto:kate.townsend@det.nsw.edu.au)

saml.det.nsw.edu.au/...  
NSW DEPARTMENT OF EDUCATION

Login with your DoE account

User ID  
Enter your user ID  
Example: jane.citizen1

Password  
Enter your password

Log in

[Forgot your password?](#)

Have trouble logging in?  
[Help for DoE staff](#)